

2020 Chorus Traffic Pattern

Nugget Casino and Resort – Second Floor

Station A

Meet just outside the Resort Tower elevator bank

Station B (- - - - -)

Travel to assigned warm-up room. Choruses may pass each other along the way.
Sierra 2 and 4 will alternate as warm-up rooms.

Station C (.....)

Travel to Ready room (Cascade 3 and 4). Performers will be walking through a non-public area of the hotel, along the loading dock area and through Cascade 1 and 2.

Station D (_____)

Travel to backstage area. Choruses may be held just outside the ballroom area until the current performer has cleared the stage.

Station E (- - - - -)

At the end of their performance, the chorus will exit down the ramp and travel to the Tunnel of Love where they will join the audience.

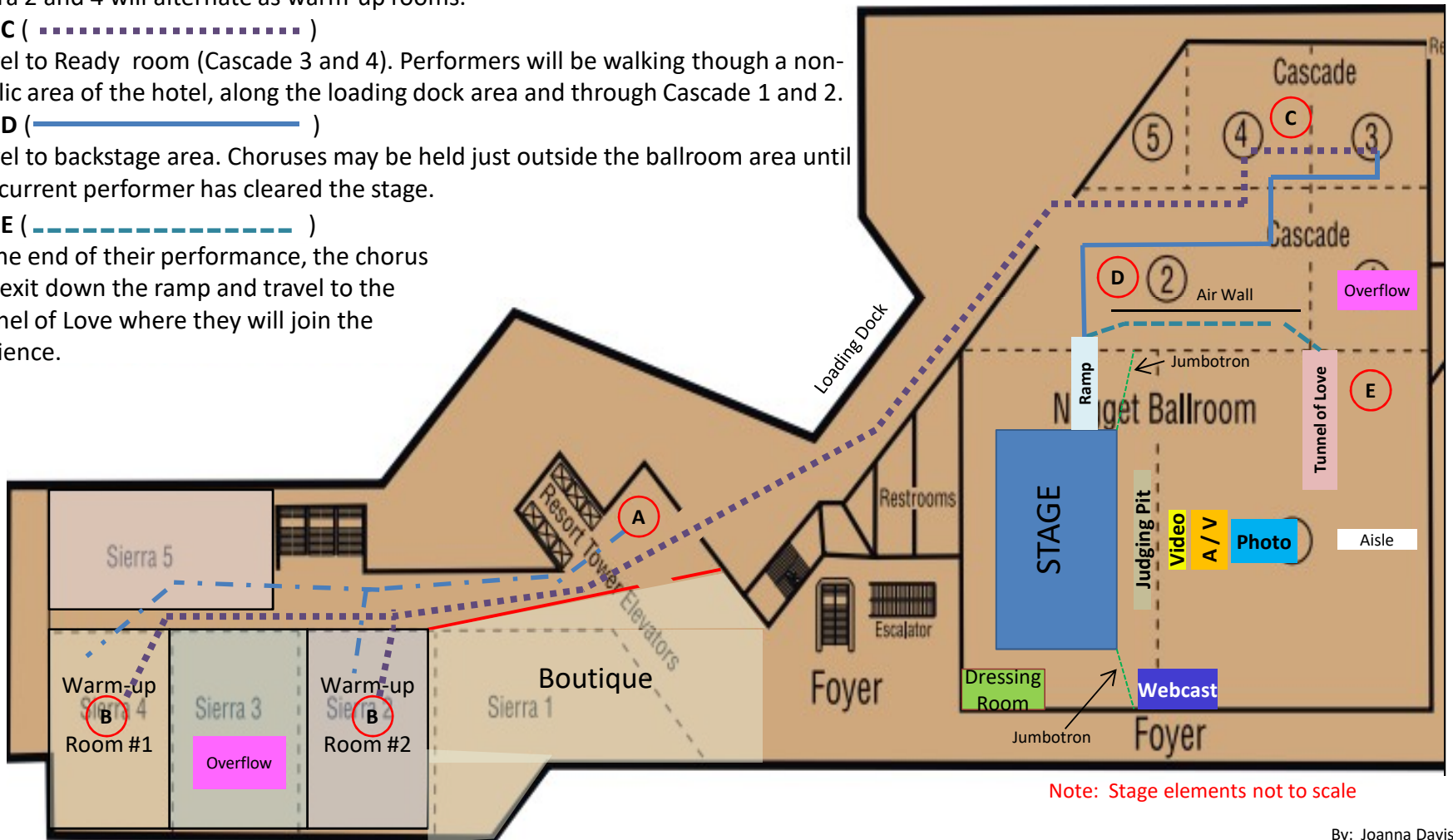

Note: Stage elements not to scale